

PASSEND FÜR / SUITABLE FOR:

P+M PT80 - PTM80
HELVI®
SINCOSALD®
WTL®
CEMONT®

Technische Daten/Technical Data:

Max. Schneidstrom/Max. current:	80 Ampere
Einschaltdauer/Duty Cycle:	60% – 80 Ampere
Schneidgas/Gas:	Luft/N ₂ /air /N ₂
Gasdruck/Gas pressure:	4,4–5,0 bar (65–75 psi)
Gasversorgung/Gas flow:	110 ltr./min. (230 scfh)
Pilot/Pilot:	Elektrode zur Düse/Electrode to tip
Zündung/Ignition:	ohne HF/without HF

Back Striking
Patent Pending

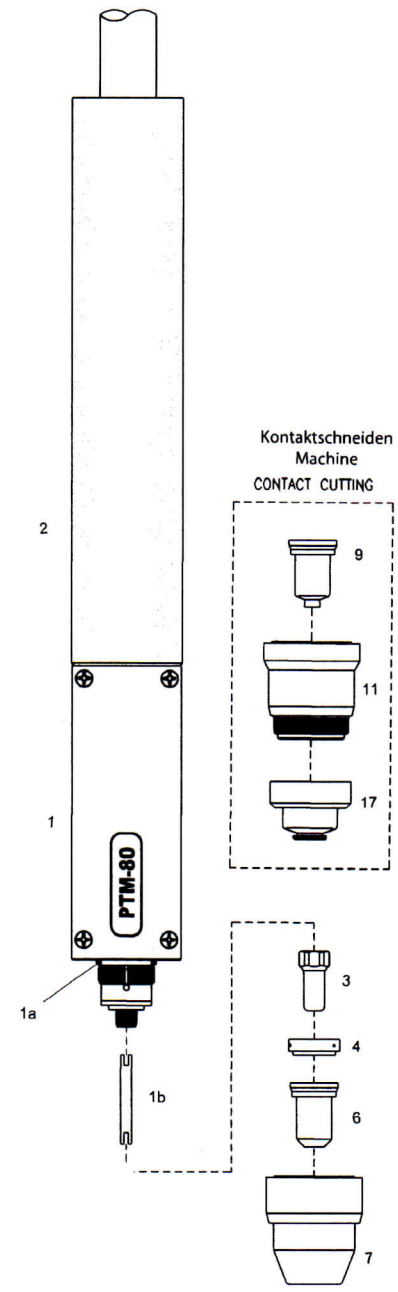
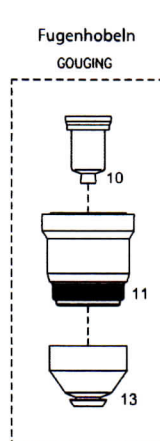
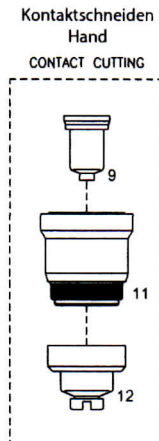
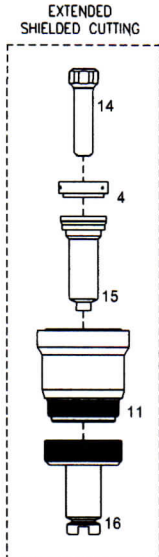
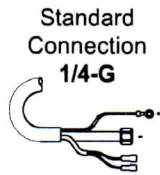
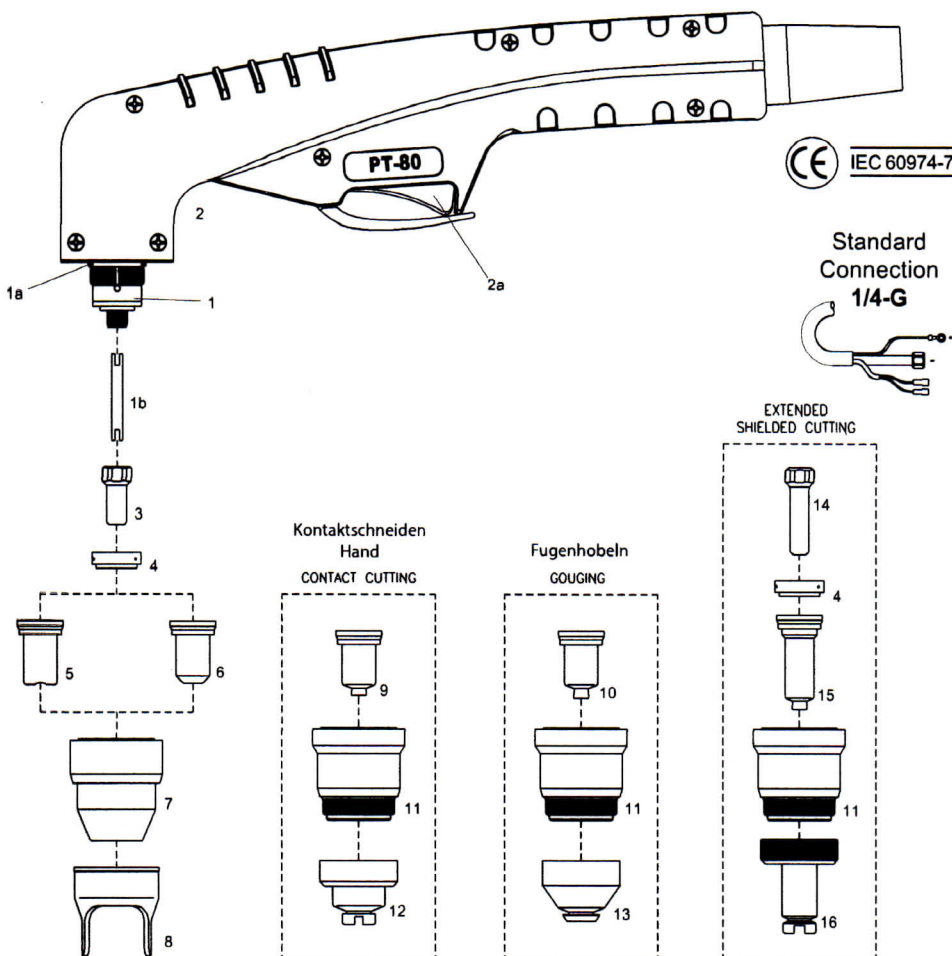



PASSEND FÜR / SUITABLE FOR:

P+M PT80 – PTM80

HELVI®

SINCOSALD®

WTL®

CEMONT®

Item	Bestell-Nr./Order No.	Ref.	Bezeichnung	Description	Euro
	05-4209820CX	09820CX	Handbrenner, 6 m G1/4 coaxial cable	Hand torch, 20.0 ft, G1/4 coaxial cable	##
	05-4209825CX	09825CX	Handbrenner, 12 m G1/4 coaxial cable	Hand torch, 40.0 ft, G1/4 coaxial cable	##
	05-4209830CX	09830CX	Maschinenbr., 6 m G1/4 coaxial cable	Machine torch 20.0ft, G1/4 coaxial cable	##
	05-4209835CX	09835CX	Maschinenbr., 12 m G1/4, coaxial cable	Machine torch 40.0ft, G1/4 coaxial cable	##
1	05-4209800	09800	Handbrennerkopf 70°	Hand torch head 70°	##
	05-4209810	09810	Maschinenbrennerkopf 180°	Machine torch head 180°	##
1a	05-4251620-60	51620.60	O-Ring 15 x 1,5	O-Ring 15 x 1,5	##
1b	05-4209800-42	09800.42	Kühlrohr	Colling tube	##
2	05-03109705	09705	Handgriff mit Microschalter	Handle with Switch	##
	05-4207218	07218	Führungsrohr	Positioning tube	##
2a	05-001758-02	07301.20	Microschalter	Switch	##
3	05-4252558	52558	Elektrode Luft, Back Striking	Elektrode Air, Back Striking	##
4	05-4260027	60027	Swirl Ring	Swirl ring	##
5	05-4251310-09	51310.09	Kontaktdüse Ø 0,9 (30-40A) Back Striking	Contact Tip Ø 0.9 (30-40A) Back Striking	##
6	05-4251311-10	51311.10	Düse Ø 1,0 (40-50 A) Back Striking	Tip Ø 1.0 (40-50 A) Back Striking	##
	05-4251311-11	51311.11	Düse Ø 1,1 (50-60 A) Back Striking	Tip Ø 1.1 (50-60 A) Back Striking	##
	05-4251311-12	51311.12	Düse Ø 1,2 (60-70 A) Back Striking	Tip Ø 1.2 (60-70 A) Back Striking	##
	05-4251311-13	51311.13	Düse Ø 1,3 (70-80 A) Back Striking	Tip Ø 1.3 (70-80 A) Back Striking	##
7	05-4260510	60510	Düsenhalter	Retaining cap	##
8	05-4260434	60434	Abstandstück mit 2 Spitzen Pos 6	Double pointed spacer Pos 6	##
9	05-4251311S10	51311S.10	Kontaktdüse Ø 1,0 (40-50A) Back Striking	Contact Tip Ø 1.0 (40-50A) Back Striking	##
	05-4251311S11	51311S.11	Kontaktdüse Ø 1,1 (50-60A) Back Striking	Contact Tip Ø 1.1 (50-60A) Back Striking	##
	05-4251311S12	51311S.12	Kontaktdüse Ø 1,2 (60-70A) Back Striking	Contact Tip Ø 1.2 (60-70A) Back Striking	##
	05-4251311S13	51311S.13	Kontaktdüse Ø 1,3 (70-80A) Back Striking	Contact Tip Ø 1.3 (70-80A) Back Striking	##
10	05-4251311G16	51311G.16	Düse 80A Fugenhobeln Back Striking	Tip 80A Gouging Back Striking	##
11	05-4260511	60511	Kontaktdüsenhalter	Contact nozzle retaining cap	##
12	05-4260504	60504	Schutzkappe; Hand	Shield cap - Hand	##
13	05-4260508	60508	Schutzkappe, Fugenhobeln	Shield cap - Gouging	##
14	05-4252558L	52558L	Elektrode, lang	Extended Electrode	##
15	05-4251311L.10	51311L.10	Düse, geschützt, lang Ø 1,0, 40-50A	Extended Shielded Tip, Ø 1.0, 40-50A	##
	05-4251311L.11	51311L.11	Düse, geschützt, lang Ø 1,1, 50-60A	Extended Shielded Tip, Ø 1.1, 50-60A	##
	05-4251311L.12	51311L.12	Düse, geschützt, lang Ø 1,2, 60-70A	Extended Shielded Tip, Ø 1.2, 60-70A	##
	05-4251311L.13	51311L.13	Düse, geschützt, lang Ø 1,3, 70-80A	Extended Shielded Tip, Ø 1.3, 70-80A	##
16	05-001757-02	60504L	Schutzkappe, lang, Hand	Extended Shield Cap, Hand	##
17	05-4260506	60506	Schutzkappe, Maschine	Shield cap - Machine	##
	05-001670-01	51853	Kreisschneideset	Circle cutting attachment	##
	05-001671-01	51809	Fahrwagen	Cutting guide	##

PLASMA PT 80

traifmeiddistribution.com

FH0931



PR0351



PE0132



Ø mm	Ø in	Cu	⚡
1.0	.040	PD0345-10	40 - 50 A
1.1	.043	PD0345-11	50 - 60 A
1.2	.045	PD0345-12	60 - 70 A
1.3	.051	PD0345-13	70 - 80 A

Pergel Takımı

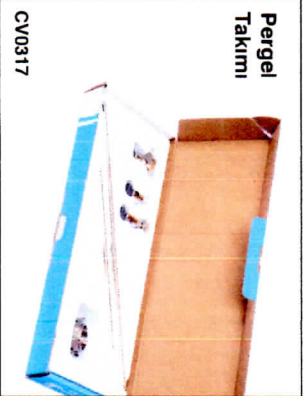

PC0347



CV0314



TP0160

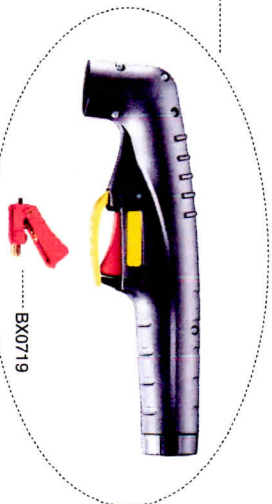

BX0719

PF0401



EA1341 OR

CV0320



TP0165

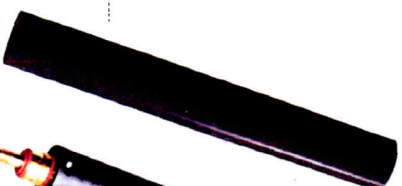

PF0406



Tüm markalar, ait oldukları firmaların özel haklarıdır. | Veriler ve görseller, tanıtım amaçlı olup önceden haber verilmesizin değiştirilebilir. | Copyright © 2016 Traifmeid Spa

